

Welcome to the
Subpod family!
Let's get started!

subpod®

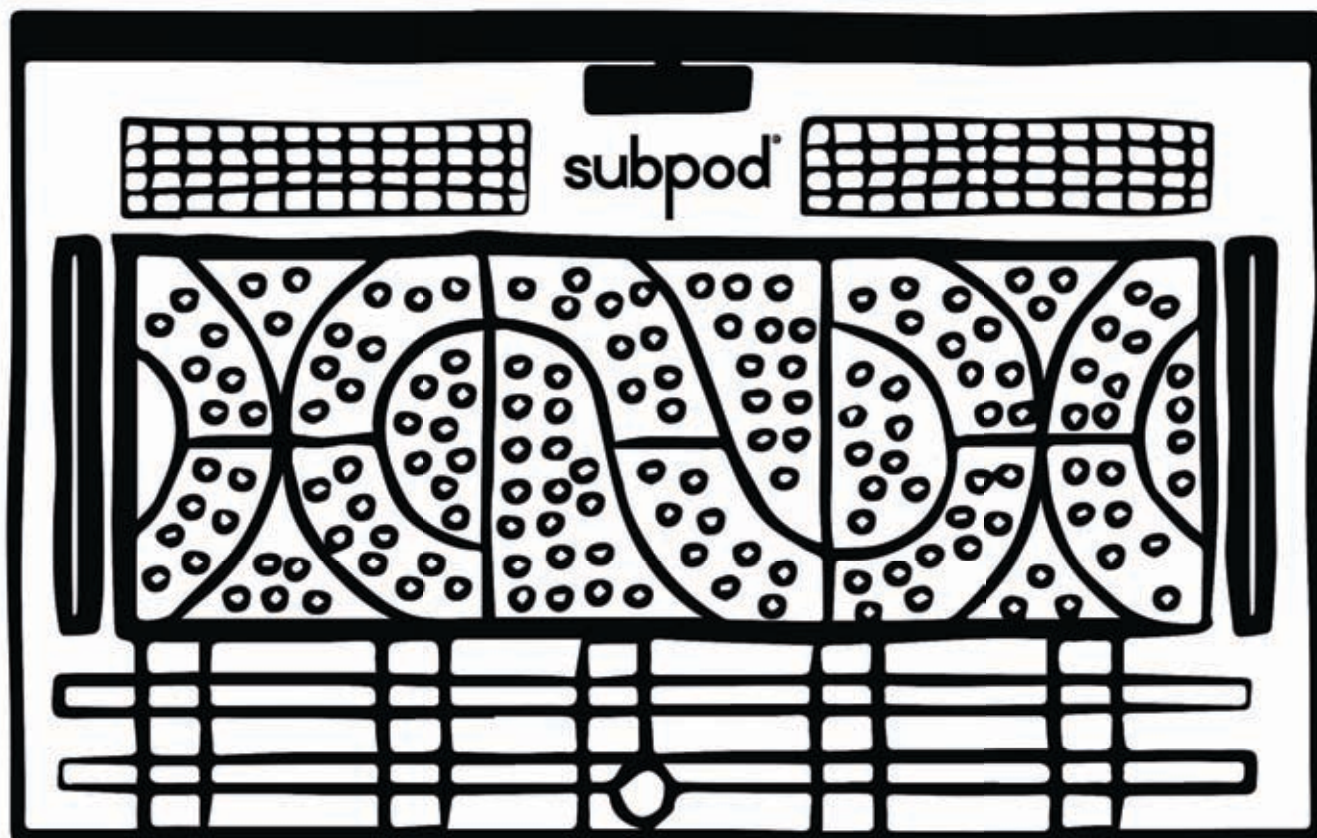

**Four
easy
steps!**

- 1 **Assemble** your Subpod
- 2 **Plant** it in your garden
- 3 **Fill** it with the essentials
- 4 **Feed** it with your waste



If you need more info during these steps, see our full
online guide with images and video at subpod.com/start

Assembling your Subpod

Skip the fuss!

Scan and follow along with
step by step videos:

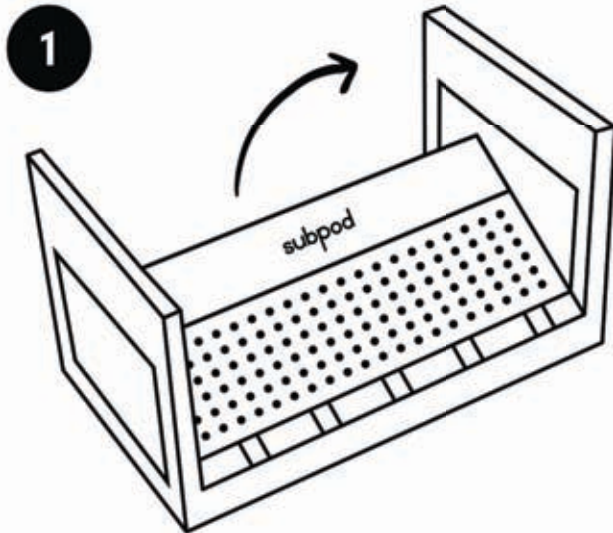

Unpack & Unfold

Gently unfold the side and front panels, pushing the hinges back into place if they don't lift easily. Lie the Subpod on the front panel and press on the joints to lock all 3 panels together. Flip & repeat with the back.

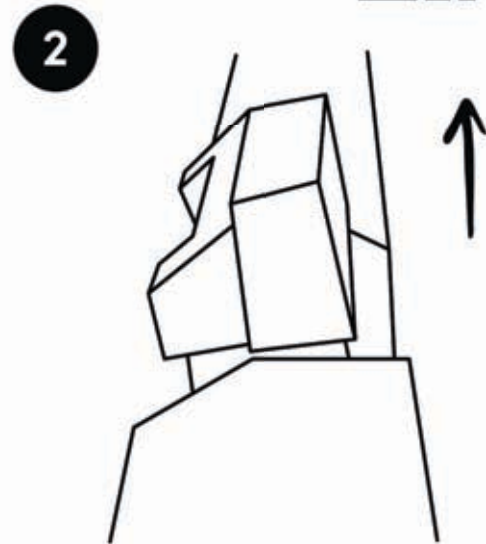

Stand Hinges Upwards

Make sure all 3 hinges on the rear wall of the Subpod are standing straight up towards the sky.

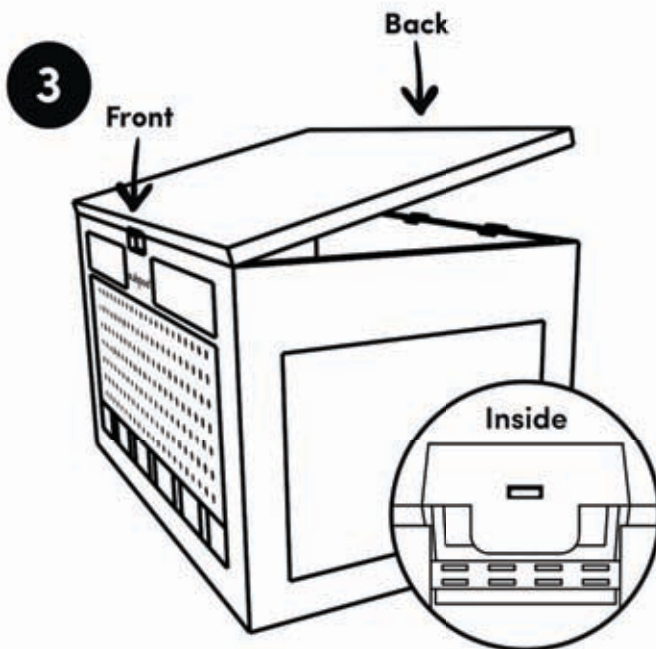

Click Lid On

To align the lid sockets with the 3 upright hinges, rest the front of the lid on the front panel. Slowly lower the back of the lid until it sits square. Press down firmly to click the hinges in place, then check inside that they're fully locked in.

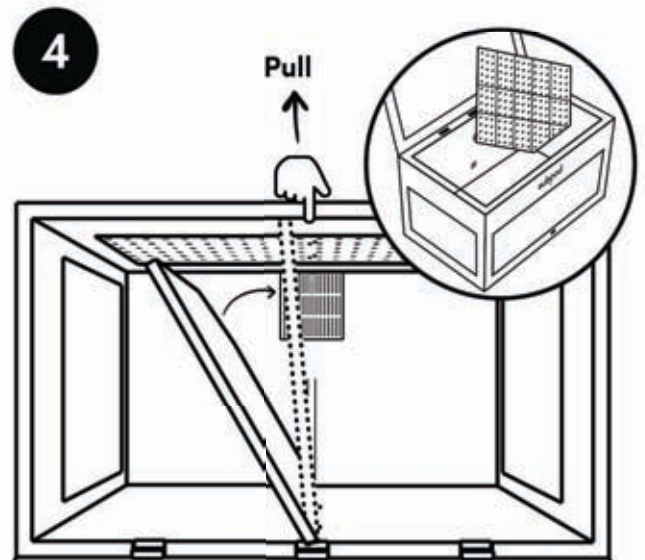

Insert Divider

There are tabs on the back and front panels for the divider to slot into. Hook the divider at an angle into the tabs on the back wall, then pull on the front panel to get room to slip the divider into place. To finish, push the divider all the way down.

Attaching the support hinge

Lean the lid against a wall to hold it upright, then follow steps 1 to 3, starting with the axle bolt at the bottom first.

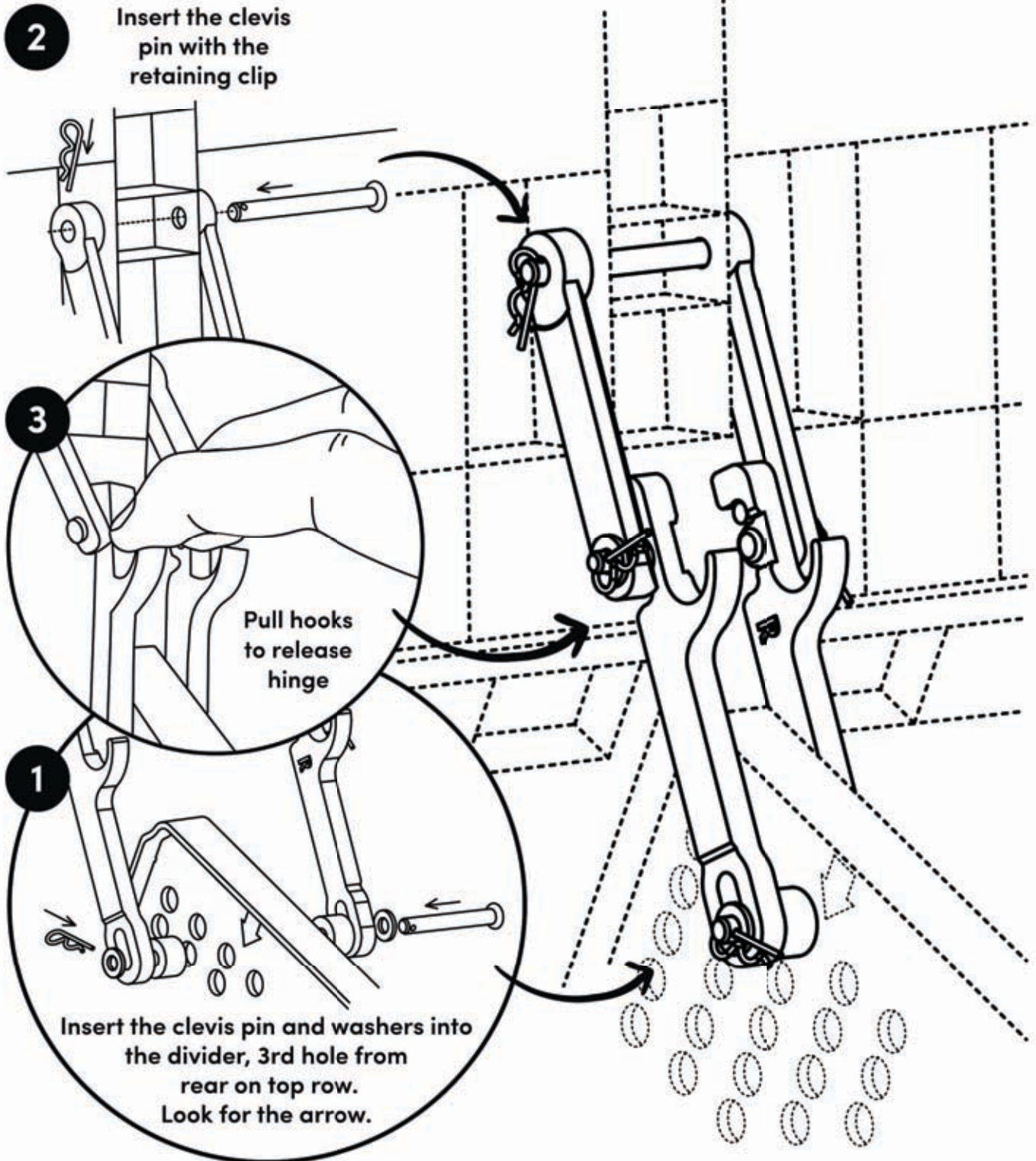

Assembly done! Before we bury the Subpod, why not take a few photos and share on social media! #subpod #compostunderground

Planting your Subpod

Let's pick a spot for your Subpod!
We recommend planting it with your
herbs and veg in a raised garden
bed. Remember it doubles as a seat!

Here's what you'll need:

- Spade or shovel
- Watering can or hose

Optional:

- Spirit level
- Measuring tape

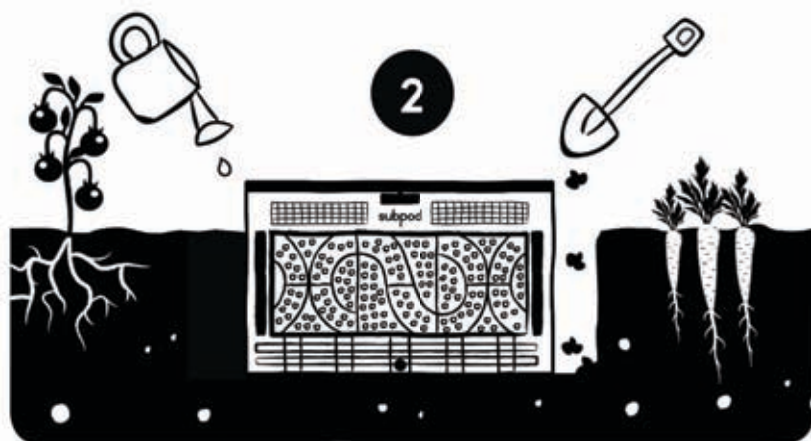
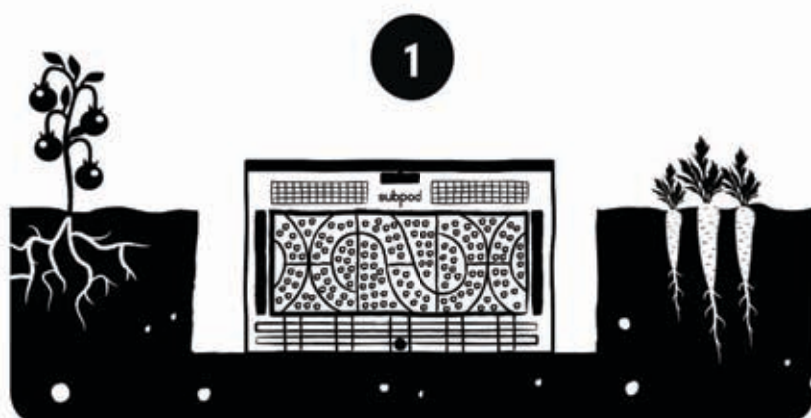

Let's get digging!

You'll be digging a hole which is:

85cm **L** x 55cm **W** x 31cm **D**
33in. **L** x 22in. **W** x 12in. **D**

That's around 8-10cm (3in.)
longer and wider than Subpod.
It's important that the top airflow
panels are above ground.

Once you're happy with the
placement, check that the
Subpod is level by eye (or with a
spirit level) and adjust by adding
or removing soil as needed.

Fill the hole around your Subpod
with soil, then water it to help
settle it into place. Repeat this
until the soil reaches the bottom
of the airflow panel.

We're aiming for a snug fit!

If you're using Subpod as a
garden seat, position it closer
to the edge of the garden bed.
Leave a gap of 3cm (1in.) from
the wall of the bed, which will
allow your worms to have some
'wriggle room' through the front.

Collecting worm juice? There's an
optional plumbing feature. Visit
subpod.com/start to watch our
step-by-step guide for setting up
your plumbing.

Filling your Subpod

Now that Subpod is in the ground, it's time to add some worms and bedding. (It is a garden 'bed' after all!)

Here's what you'll need:

- 2000+ composting worms with castings (500g / 1.1lb)
- Worm blanket, moistened (comes in the box)
- 8 good handfuls of 'bedding' material (pick any of the below):
 - Coir / coconut peat
 - Shredded newspaper
 - Subpod's cardboard packaging, torn into small pieces



1

Add bedding material

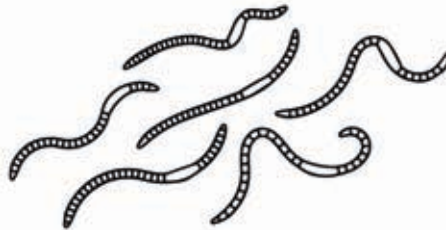

2

Add worms and castings

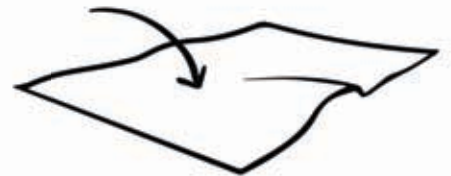

3

Add moist worm blanket

*Add all 3 ingredients on **both** sides of the internal divider

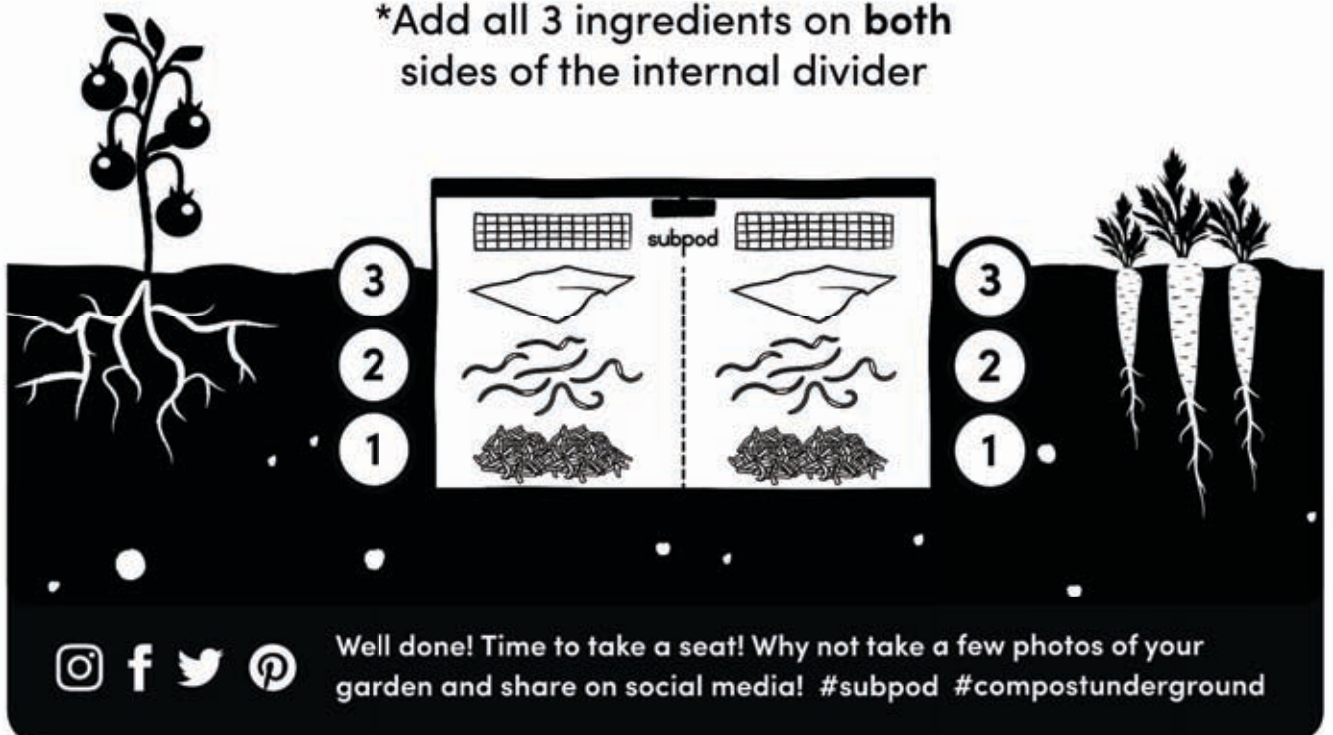

subpod

Feeding your Subpod

Subpod is kind of like a child or a pet – only far less maintenance! So, it needs to be fed well and looked after to get the best results. Here's some general tips, and there's more inside your Subpod lid.

Don't feed Subpod for the first week. This let's the worms settle in.



1 Add food scraps
(don't overfeed)



2 Add dry carbon with
each feeding



3 Aerate with
each feeding



Refer to the inside of
your Subpod lid for
more info on feeding

Support

Visit www.subpod.com, or join the composting community at growhub.subpod.com for more helpful information and resources to improve your composting, and for one-on-one support.

Did you know?

A compost worm can
eat its own weight
in food waste
every day!